

Product Information

Universal Conveyor GDFuni

Application Area

Gerco vacuum conveyors of the construction series **GDFuni** are used for conveying heavily flowing powders and plastics pellets. These units are equipped with a compressed air unit for automatic filling of metering and mixing devices and of dryers with powders and pellets. The GDFuni conveyor achieves a maximum conveying output of 250 kg/h (pellets).



Vacuum generator underneath the cover

Standard Features:

- Material separating hopper made of stainless steel
- Electronic control system MKS 04
- Compressed air filter cleaning device
- Conveying times and conveying cycle separately adjustable
- Aspiration lance \varnothing 40
- Flexible conveying pipe made of PU \varnothing 40 incl. a steel spiral

Product Information

Technical Data

Mechanical Data

Dimensions (ø x H) in mm hopper	ø 170 x 635
Weight in kg	9,2
3m hose weight & lance in kg	2,5
Capacity in liter	2
Conveying performance (max. by granulates) kg/h	250
Conveying height max. m	4
Conveying length max. m	30

Electrical Data

Connection load V / Hz	230 V / 50
Power consumption VA	10
Air connection bar	6
Air consumption by 6 m conveying length m ³ /kg*	0,1
Noise level 1m distance dB	69

*The air consumption depends on the form of the granulate, the conveying height and the conveying length.

Hopper flange

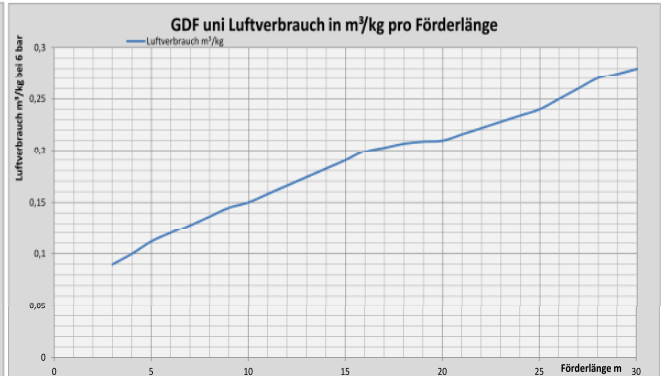
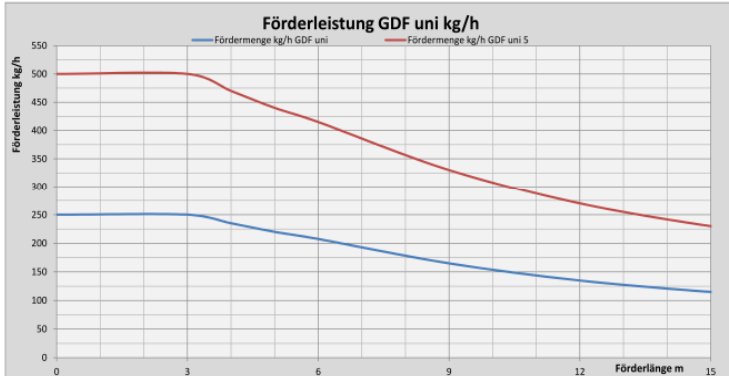
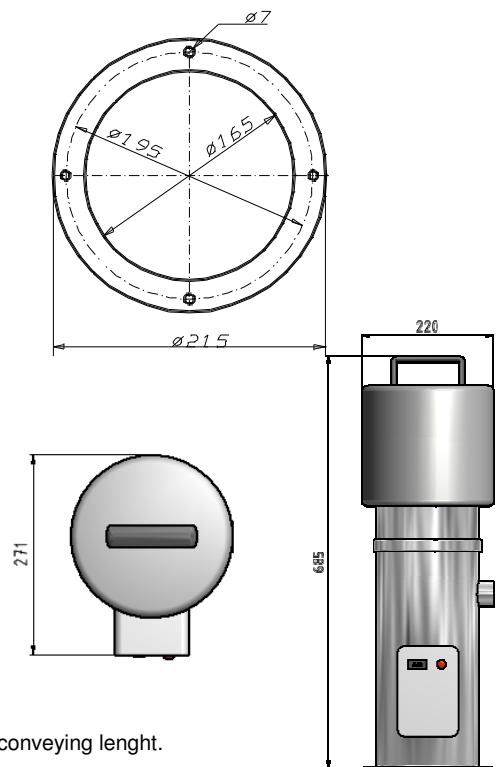

Universal Conveyor GDFuni

Accessories

Two-components switch ZKW 11

to convey two materials

Flashlight

Adaptor container

To mount the conveyor unit onto the machine